

GROUP

H

HULL

HULL

CONTENTS

	Page
DRIVERS SEAT	H6
FLOOR PLATES AND COVERS	H4
HULL FITTINGS	H1
Drivers Hatch and Visor	H2
Engine Cover Assembly	H1
INDIVIDUAL SEAT	H6
ROOF COVER AND FITTINGS	H5
WINGS AND FITTINGS	H5

LIST OF ILLUSTRATIONS

(NOTE:- THE TEXT DOES NOT NECESSARILY INCLUDE ALL THE ITEMS REFERENCED)

	Plate
BODY AND FLOOR PLATES	H1
DRIVERS SEAT	H3
GUNNERS SEAT	H4
GUNNERS SEAT	H5
PERISCOPE VISOR	H2

Item No.	Catalogue Number	Item Name	Item Description	No. Off	Plate Ref.	Drawing No.	Remarks
1		HULL -					
2	LV6MT1/3120-99-800-9352	BEARING, SLEEVE	0.5025 in. id x 0.6270 in. od x 1 in. lg	3			
3	LV9ASC/2510-99-815-6221	NUT, SQUARE	UNF, steel, 3/8 in.	36		FV50271	
4	LV9ASC/2510-99-815-6222	CAGE, SQUARE NUT	steel, 3/8 in.	36		FV50272	
5	G1/GA19402	NUT, PLAIN, WELDING	no.10 x 0.6 in. with ferrule	5			
6	G1/GA19403	NUT, PLAIN, WELDING	UNF, 1/4 in. x 1/2 in. with ferrule	6			
7	G1/GA19404	NUT, PLAIN, WELDING	UNF, 1/4 in. x 1 in. with ferrule	1			
8	G1/GA19408	NUT, PLAIN, WELDING	UNF, 5/16 in. x 29/32 in. with ferrule	12			
9	G1/GA19409	NUT, PLAIN, WELDING	UNF, 5/16 in. x 1 in. with ferrule	7			
10	G1/GA19410	NUT, PLAIN, WELDING	UNF, 5/16 in. x 1-1/8 in. with ferrule	3			
11	G1/GA19411	NUT, PLAIN, WELDING	UNF, 3/8 in. x 45/64 in. with ferrule	8			
12	G1/5307-99-943-4220	STUD, WELDING	UNF, 1/4 in. x 1/2 in.	84			
13	G1/5307-99-943-4221	STUD, WELDING	UNF, 1/4 in. x 5/8 in.	4			
14	G1/5307-99-943-4205	STUD, WELDING	UNF, 5/16 in. x 1/2 in.	32			
15	G1/5307-99-943-4206	STUD, WELDING	UNF, 5/16 in. x 5/8 in.	9			
16	G1/5307-99-943-4207	STUD, WELDING	UNF, 5/16 in. x 3/4 in.	50			
17	G1/5307-99-943-4211	STUD, WELDING	UNF, 5/16 in. x 1-1/4 in.	4			
18	G1/5307-99-943-4226	STUD, WELDING	UNF, 3/8 in. x 3/4 in.	14			
19	G1/5307-99-943-4227	STUD, WELDING	UNF, 3/8 in. x 7/8 in.	4			
20	G1/5307-99-943-4231	STUD, WELDING	UNF, 3/8 in. x 1-3/8 in.	2			
21	G1/5307-99-943-4240	STUD, WELDING	UNF, 1/2 in. x 1 in.	8			
22	G1/3432-99-120-8201	FERRULE, PROJECTION WELDING	ceramic, 0.26 in. id x 0.46 in. od x 0.40 in. h	88			
23	G1/3432-99-120-2297	FERRULE, PROJECTION WELDING	ceramic, 0.33 in. id x 0.56 in. od x 0.39 in. h	95			
24	G1/3432-99-120-8202	FERRULE, PROJECTION WELDING	ceramic, 0.39 in. id x 0.68 in. od x 0.46 in. h	20			
25	G1/3432-99-120-8204	FERRULE, PROJECTION WELDING	ceramic, 0.52 in. id x 0.83 in. od x 0.48 in. h	8			
26							
27		HULL FITTINGS -					
28	LV9ASC/2510-99-815-6405	COVER ASSEMBLY, ENGINE		1		FV59198	
29	G1/5310-99-120-2521	WASHER, LOCK	steel, int, flat, zinc coated, 3/8 in.	16			Cover to hull
30	LV9ASC/5305-99-815-6266	SCREW, SET	UNF, steel, hex hd, 60 deg x 0.26 in. lg, 3/8 in. x 1 in.	16			
31	LV9ASC/2510-99-815-6407	COVER, ENGINE HATCH	rh	1	1	FV51219	Cover to hull
32	LV9ASC/2510-99-815-6265	PIN, HINGE, ENGINE HATCH	rh	1		FV59200	
33	G1/5315-99-942-0385	PIN, COTTER, SPLIT	steel, phosphated, 3/4 in. dia x 1-1/2 in. lg	1		FV51206	
34	LV9ASC/2510-99-815-6265	COVER, ENGINE HATCH	lh	1	2	FV59199	Used on Mk 1 and Mk 2 only
35	LV9ASC/2510-99-815-6224	PIN, HINGE, ENGINE HATCH	lh	1		FV50289	
36	G1/5315-99-942-3566	PIN, GROOVED, HEADLESS	steel, GP1, phosphated, 1/8 in. dia x 7/8 in. lg	1			
37	LV9ASC/2510-99-815-6343	CATCH ASSEMBLY, ENGINE		4		FV55126	Used on Mk 1 and Mk 2 only
38	LV9ASC/5310-99-815-6338	WASHER, LOCK	steel, double coil, 1/2 in.	4		FV52169	
39	LV9ASC/5305-99-815-6449	BOLT, SHOULDER	UNF, steel, sq, extended, 3/8 in. x 1 in.	4		FV50285	
40	LV9ASC/FV50288	SCREW, MACHINE		8			Catch to hatch
41	G1/5305-99-941-6550	SCREW, MACHINE	UNF, steel, hex hd, zinc coated, 3/8 in. x 1 in.	8	3		
42	G1/5310-99-120-2521	WASHER, LOCK	steel, int, flat zinc coated, 3/8 in.	8			
43	G1/5310-99-941-0926	NUT, PLAIN, HEXAGON	UNF, steel, zinc coated, 3/8 in.	8			Louvre to hull
44	LV9ASC/2510-99-815-6409	LOUVRE ASSEMBLY, AIR		1	4	FV59215	
45	LV9ASC/2510-99-815-6221	NUT, SQUARE	UNF, steel, 3/8 in.	12		FV50271	
46	LV9ASC/2510-99-815-6222	CAGE, SQUARE NUT	UNF, steel, 3/8 in.	4		FV50272	
47	G1/5310-99-120-2521	WASHER, LOCK	steel, int, flat, zinc coated, 3/8 in.	8			Louvre to hull
48	G1/5305-99-941-0540	SCREW, MACHINE	UNF, steel, hex hd, zinc coated, 3/8 in. x 7/8 in.	8			
49	LV9ASC/2510-99-815-6459	COVER ASSEMBLY, ENGINE		1		FV59579	
50	LV9ASC/2510-99-815-6407	COVER, ENGINE HATCH	rh	1	1	FV59200	Used on Mk1/1 Mk 2/3 and Mk 2/6
51	LV9ASC/2510-99-815-6265	PIN, HINGE, ENGINE HATCH	rh	1		FV51206	
52	G1/5315-99-942-0385	PIN, COTTER, SPLIT	steel, phosphated, 3/4 in. dia x 1-1/2 in. lg	1			
53	LV9ASC/2510-99-815-6265	COVER, ENGINE HATCH	lh	1	2	FV59199	Used on Mk1/1 Mk 2/3 and Mk 2/6
54	LV9ASC/2510-99-815-6224	PIN, HINGE, ENGINE HATCH	lh	1		FV50289	
55	G1/5315-99-942-3566	PIN, GROOVED, HEADLESS	steel, GP1, phosphated, 1/8 in. dia x 7/8 in. lg	1			
56	LV9ASC/2510-99-815-6343	CATCH ASSEMBLY, ENGINE		6		FV55126	Used on Mk1/1 Mk 2/3 and Mk 2/6
57	LV9ASC/5310-99-815-6338	WASHER, LOCK	steel, double coil, 1/2 in.	6		FV52169	
58	LV9ASC/5305-99-815-6449	BOLT, SHOULDER	UNF, steel, sq extended, 3/8 in x 1 in.	6		FV50285	
59	LV9ASC/FV50288	SCREW, MACHINE		12			

Item No.	Catalogue Number	Item Name	Item Description	No. Off	Plate Ref.	Drawing No.	Remarks
1		HULL FITTINGS - Contd			H1		
2		COVER ASSEMBLY, ENGINE -Contd					
3	G1/5305-99-941-6550	SCREW, MACHINE	UNF, steel, hex hd, zinc coated, 3/8 in. x 1 in.	12	3		} Catch to Hatch
4	G1/5310-99-120-2521	WASHER, LOCK	steel, int, flat, zinc coated, 3/8 in.	12			
5	G1/5310-99-941-0926	NUT, PLAIN, HEXAGON	UNF, steel, zinc coated, 3/8 in.	12			} Used on Mk 1/1, Mk 2/3 and Mk 2/6
6	LV9ASC/2510-99-815-6458	LOUVRE ASSEMBLY, AIR		1	4	FV59596	
7	LV9ASC/2510-99-815-6221	NUT, SQUARE	UNF, steel, 3/8 in.	12		FV50271	} Louvre to hull
8	LV9ASC/2510-99-815-6222	CAGE, SQUARE	UNF, steel, 3/8 in.	4		FV50272	
9	G1/5310-99-120-2521	WASHER, LOCK	steel, int, flat, zinc coated, 3/8 in.	8			
10	G1/5305-99-941-0540	SCREW, MACHINE	UNF, steel, hex hd, zinc coated, 3/8 in. x 7/8 in.	8			} carrier spare wheel
11	LV9ASC/2510-99-815-6478	DOOR, HATCH, VEHICULAR		1	5	FV59635	
12	LV9ASC/2590-99-815-7351	LID ASSEMBLY, SPARE WHEEL CARRIER		1		FV11324	
13	LV6MT14/5310-99-910-7654	NUT, WHEEL STUD	UNF, steel, Cd plated, 5/8 in.	4			} auxiliary container
14	LV9ASC/2510-99-815-6477	DOOR, HATCH, VEHICULAR		1		FV59634	
15	G1/GA19479	STUD, WELDING	UNF, steel, 3/8 in. x 1 in.	8			
16	LV9ASC/2510-99-815-6351	HANDLE ASSEMBLY, RELEASE ESCAPE DOOR		2		FV55423	
17	G1/GA50552	PIN, GROOVED, HEADLESS	steel, GP1, 7/16 in. dia x 1-5/8 in. lg	4			Handle hinge
18	G1/5315-99-942-3597	PIN, GROOVED, HEADLESS	steel, phosphated, GP1, 1/4 in. dia x 1-1/2 in. lg	4			Handle stop
19	LV9ASC/2510-99-104-4425	CHAIN, ASSEMBLY, SINGLE LEG	steel, 12 SWG x 6-1/4 in. lg	2			
20	LV9ASC/2510-99-815-6389	CROSS TUBE ASSEMBLY, ENGINE COMPARTMENT		1		FV58585	
21	LV9ASC/2530-99-815-6387	BRACKET, EYE, ROTATING SHAFT	rh	1		FV58583	
22	LV9ASC/2530-99-815-6388	BRACKET, EYE, ROTATING SHAFT	lh	1		FV58584	
23	LV9ASC/2510-99-815-6352	SHIM	cross tube bracket	as req		FV55445	
24	LV9ASC/2510-99-815-6357	PIN, FORK END	cross tube hull	2		FV52162	
25	G1/5310-99-941-0884	NUT, PLAIN, HEXAGON	UNF, steel, slotted, zinc coated, 1/2 in.	2			
26	G1/5315-99-942-0385	PIN, COTTER, SPLIT	steel, phosphated, 3/32 in. dia x 1-1/4 in. lg	2			
27	LV9ASC/2510-99-815-6412	COVER, PLATE, ACCESS		1		FV59272	
28	G1/5310-99-120-2521	WASHER, LOCK	steel, int, flat, zinc coated, 3/8 in.	20			
29	LV9ASC/5305-99-815-6269	SCREW, SET	UNF, steel, hex hd, 60 deg point, 3/8 in. x 1-1/8 in.	20		FV51236	
30	LV9ASC/FV51465	PLUG, STARTING HANDLE HOLE		1			} Starting handle
31	LV9ASC/5310-99-815-6314	WASHER, FLAT	Al, 1-21/32 in. dia	1		FV51773	
32	LV9ASC/2910-99-815-7565	COVER PLATE, ACCESS	rh fuel drain	1		FV55738	
33	LV9ASC/2910-99-815-7564	COVER PLATE, ACCESS	lh fuel drain	1		FV55730	
34	LV9ASC/2910-99-815-7563	GASKET	fuel drain	2		FV55725	
35	LV9ASC/2510-99-815-6364	COVER PLATE, ACCESS	hull drain	5		FV55720	
36	LV9ASC/2510-99-815-6363	JOINT, COVER, HULL DRAIN		5		FV55718	
37	G1/GA13571	CHAIN	steel, no. 2	as req			
38	G1/5310-99-120-2521	WASHER, LOCK	steel, int, flat, zinc coated, 3/8 in.	42			} Cover to hull
39	G1/5305-99-941-7089	SCREW, MACHINE	UNF, steel, hex hd, zinc coated, 3/8 in. x 5/8 in.	42			
40	LV9ASC/2510-99-815-7423	PLATE, DESIGNATION	scout car, 4 x 4, liaison, FV701C	1		FV55620	Mk 1
41	LV9ASC/2510-99-815-7388	PLATE, DESIGNATION	scout car, 4 x 4, recce. FV701E	1		FV55621	Mk 2
42	LV9ASC/2510-99-815-6452	PLATE, DESIGNATION	scout car, recce. FV701H	1		FV55918	Mk 2/3
43	G1/5310-99-941-3524	NUT, SELF-LOCKING, HEXAGON	UNF, steel, nylon insert, zinc coated, 1/4 in.	4			Plate to hull
44	LV9ASC/2510-99-815-6217	CLAMP ASSEMBLY, SPRING		1		FV50226	} Centre lookout
45	LV9ASC/2510-99-815-6218	SPRING, HELICAL, TORSION		1		FV50227	
46	LV9ASC/2510-99-815-6219	PIN, HINGE, CLAMP		1			
47	G1/5315-99-942-3563	PIN, GROOVED, HEADLESS	steel, GP1, phosphated, 1/8 in. dia x 1/2 in. lg	1			
48					H2		
49		DRIVERS HATCH AND VISOR - PAD ASSEMBLY, BROW, DRIVERS					
50	LV9ASC/2510-99-815-6347	BROW PAD ASSEMBLY, DRIVERS	front	1	1-49	FV55278	
51	LV9ASC/2540-99-815-6355	BROW PAD ASSEMBLY, DRIVERS	side visor	2		FV55520	
52	LV9ASC/2540-99-815-6357	BROW PAD ASSEMBLY, VISORS	side flap	2		FV55587	
53	LV9ASC/2540-99-810-6801	PAD, CUSHIONING	drivers hd, rear	2		FV687350	
54	G1/5305-99-941-6546	SCREW, MACHINE	UNF, steel, hex hd, zinc coated, 5/16 in. x 3/4 in.	6	2		} Pad to flap hinges
55	G1/GA19171	WASHER, LOCK	steel, flat, int, zinc coated, 5/16 in.	6	3		
56	G1/5310-99-941-0925	NUT, PLAIN, HEXAGON	UNF, steel, zinc coated, 5/16 in.	6	4		

Item No.	Catalogue Number	Item Name	Item Description	No. Off	Plate Ref.	Drawing No.	Remarks
1		HULL FITTINGS - Contd					
2		DRIVERS HATCH AND VISOR - Contd			H2		
3	LV9ASC/5306-99-815-6296	EYEBOLT	UNF, steel, 3.075 in. lg	2	5) Drivers hatch to hull
4	G1/5310-99-944-3221	NUT, WING	UNF, brass, tin plated, 3/8 in.	2	6		
5	LV9ASC/5315-99-815-6540	PIN, STRAIGHT, HEADED	steel, Cd plated, 3/8 in. dia x 1-1/8 in. lg	2	7		
6	G1/5315-99-944-0172	PIN, COTTER, SPLIT	steel, phosphated, 1/16 in. dia x 7/8 in. lg	2	8		
7	LV9ASC/2510-99-815-6472	DOOR, HATCH, VEHICULAR	front hatch	1	9	FV59628	
8	LV9ASC/2510-99-815-6344	HINGE, DRIVERS ESCAPE DOOR		2	10	FV55214	
9	G1/5306-99-120-2865	BOLT, MACHINE	WF, steel, hex hd, zinc coated, 1/2 in. x 1-3/4 in.	6	11		
10	LV9ASC/2510-99-815-6228	STRIP ASSEMBLY, HINGE		2		FV50583	
11	LV9ASC/2510-99-815-6227	SPLASH		2	12	FV50580	
12	G1/5315-99-944-3582	PIN, HINGE, DRIVERS HATCH	steel, WF, phosphated, 3/16 in. dia x 7/8 in. lg	2	13		
13	LV9ASC/5306-99-815-6229	PIN, GROOVED, HEADLESS	WF, steel, sq hd, 1/2 in. x 1-19/64 in.	2	14	FV50584	
14	LV9ASC/5310-99-815-6338	BOLT, MACHINE	steel, double coil, 1/2 in.	2	15	FV52169	
15	LV9ASC/2510-99-815-6230	WASHER, LOCK		2	16	FV50585	
16	G1/5310-99-944-7127	HANDLE, LOCKING, DRIVERS DOOR		2	17		
17	G1/5310-99-944-7127	NUT, SELF LOCKING, HEXAGON	WF, steel, Cd plated, 1/2 in.	2	18	FV59629	
18	LV9ASC/2510-99-815-6468	DOOR, HATCH, VEHICULAR	front visor	1	19	FV55265	
19	LV9ASC/2510-99-815-6345	LEVER ASSEMBLY, FRONT FLAT		1		FV55630	
20	LV9ASC/2510-99-815-6473	DOOR, HATCH, VEHICULAR	rh visor	1		FV51676	
21	LV9ASC/2510-99-815-6300	LEVER ASSEMBLY, SIDE FLAP	lh visor	1		FV55631	
22	LV9ASC/2510-99-815-6474	DOOR, HATCH, VEHICULAR	rh rear	1		FV51675	
23	LV9ASC/2510-99-815-6275	LEVER ASSEMBLY, REAR FLAP	lh rear	1		FV59632	
24	LV9ASC/2510-99-815-6246	DOOR, HATCH, VEHICULAR		1		FV50729	
25	LV9ASC/2510-99-815-6476	LEVER ASSEMBLY, REAR FLAP		1		FV59633	
26	LV9ASC/2510-99-815-6247	DOOR, HATCH, VEHICULAR		1		FV50730	
27	G1/5315-99-944-4430	PIN, GROOVED, HEADLESS	steel, phosphated, WF9, 3/8 in. dia x 1-5/8 in. lg	14	20		Flap hinges
28	LV9ASC/5315-99-815-6235	PIN, STRAIGHT, HEADED	steel, phosphated, 1/2 in. dia x 2-3/4 in. lg	10	21	FV50711	
29	G1/5315-99-944-0177	PIN, COTTER, SPLIT	steel, phosphated, 3/32 in. dia x 1-1/8 in. lg	10	22		
30	LV9ASC/FV50712	SCREW, MACHINE	adjusting flap	8	23		
31	G1/5310-99-944-0925	NUT, PLAIN, HEXAGON	UNF, steel, zinc coated, 5/16 in.	8	24	FV50155	
32	LV9ASC/2510-99-815-6209	SPRING, HELICAL, COMPRESSION	visor control	8	25	FV50713	
33	LV9ASC/2510-99-815-6237	PLUNGER, DETENT		8	26	FV50714	
34	LV9ASC/2510-99-815-6238	LATCH, VISOR FLAP SNAP CATCH		8	27	FV50165	
35	LV9ASC/2510-99-815-6210	SPRING, HELICAL, COMPRESSION	flap handle	8	28	FV50166	
36	LV9ASC/2510-99-815-6211	SEAT, COMPRESSION	flat handle	16	29	FV50720	
37	LV9ASC/2510-99-815-6241	HELICAL SPRING	flap link	8	30	FV50762	
38	LV9ASC/2510-99-815-6248	SEAT, COMPRESSION	flap link	8		FV50722	
39	LV9ASC/2510-99-815-6243	SPRING, HELICAL, EXTENSION	ride and rear flaps	6		FV50721	
40	LV9ASC/2510-99-815-6242	SEAT, COMPRESSION, HELICAL SPRING	drivers front flat	2	31	FV50171	
41	LV9ASC/2510-99-815-6213	RING, RETAINING	steel, 3/4 in. id	8	32	FV50168	
42	LV9ASC/2510-99-815-6212	PIN, JOINT, LINK CATCH		8	33		
43	G1/5315-99-944-0177	PIN, COTTER, SPLIT	steel, phosphated, 3/32 in. dia x 1-1/8 in. lg	8	34	FV50718	
44	LV9ASC/2510-99-815-6239	LEVER ASSEMBLY, STUD		3	35	FV50719	
45	LV9ASC/2510-99-815-6240	LEVER ASSEMBLY, STUD	side visors	3	36	FV50724	
46	LV9ASC/2510-99-815-6245	LINK, SOLID, VISOR FLAP	rear lockouts and front visor	4	37	FV50723	
47	LV9ASC/2510-99-815-6244	LINK, SOLID, VISOR FLAP		4	38		
48	G1/5315-99-944-3582	PIN, GROOVED, HEADLESS	steel, phosphated, 3/16 in. dia x 7/8 in. lg	4	39		
49	LV9ASC/FV50172	PIN, JOINT, VISOR FLAP		4			
50	G1/5315-99-944-0177	PIN, COTTER, SPLIT	steel, phosphated, 3/32 in. dia x 1-1/8 in. lg	8			

Item No.	Catalogue Number	Item Name	Item Description	No. Off	Plate Ref.	Drawing No.	Remarks
1		HULL FITTINGS - Contd				H 2	
2		DRIVERS HATCH AND VISOR - Contd					
3	LV9ASC/2510-99-815-6249	SPRING, HELICAL, EXTENSION	flap operating	6	40	FV50763	
4	LV9ASC/2510-99-815-6277	HANDLE, LOCKING, PERISCOPE	rh	1	41	FV51114	
5	LV9ASC/2510-99-815-6276	HANDLE, LOCKING, PERISCOPE	lh	1	42	FV51113	
6	LV9ASC/5305-99-815-6207	SCREW, SET	UNF, steel, ch hd, slotted, 1/4 in. x 1/2 in.	5	43	FV50152	
7	LV9ASC/2510-99-815-6208	PLUNGER, DETENT		5	44	FV50153	
8	LV9ASC/2510-99-815-6200	SPRING, HELICAL, COMPRESSION		5	45	FV4703	
9	LV9ASC/4730-99-815-6264	PLUG, SCREWED	UNF, steel, slotted, 5/8 in. x 5/8 in.	5	46	FV51193	
10	LV9ASC/5310-99-815-6338	WASHER, LOCK	steel, double coil, 1/2 in. id	1	47	FV52169	
11	LV9ASC/2510-99-815-6231	HANDLE, LOCKING, DRIVERS FLAP		1	48	FV50586	} Locking front visor flat
12	G1/5310-99-941-7127	NUT, SELF-LOCKING, HEXAGON	UNF, steel, Cd plated, nylon insert, 1/2 in.	1	49	FV55121	
13	LV9ASC/2510-99-815-6342	SCREEN ASSEMBLY	w/glass block	1			} 2 hull spare
14	LV9ASC/2510-99-815-6339	CASING, SIDE VISOR SCREEN		1		FV55119	
15	LVEXT1/8305-99-802-2205	FELT, WOOL, COMPRESSED	1/8 in. thk	1	as req		
16	LV5EM/TL2776	BLOCK, TRIPLEX	7 in. w x 3-1/4 in. lg x 3/4 in. thk	1			
17	LV9ASC/2510-99-815-6216	PANEL, TRANSPARENT, VISOR SCREEN		1		FV50224	
18	LVEXT1/8305-99-802-2206	FELT, WOOL, COMPRESSED	1/4 in. thk	1	as req		
19	LV9ASC/2510-99-815-6340	PLAIN, STRIP, SIDE VISOR SCREEN		1		FV55119	
20	LV9ASC/2510-99-815-6341	STRIP, TAPPED, VISOR CASING		1		FV55120	
21	G1/5305-99-941-1749	SCREW, MACHINE	UNF, steel, csk hd, zinc coated, 1/4 in. x 5/8 in.	21		FV59287	
22	WF	WINDSCREEN ASSEMBLY		1			
23	LV9ASC/FV58403	WINDSCREEN		1		FV59288	
24	LV9ASC/2510-99-815-6415	FRAME ASSEMBLY WINDSCREEN		1		FV59286	
25	G1/5305-99-941-7941	SCREW, TAPPING, THREAD FORMING	steel, rd hd, flat point Cd plated, no.4 x 3/16 in.	14		FV51795	
26	LV9ASC/2510-99-815-6316	BRACKET, WINDSCREEN		1			
27		FLOOR PLATES AND COVERS -				H 1	
28		TUNNEL, PROPELLOR SHAFT, RIGHT		1		FV59169	
29	LV9ASC/2510-99-815-6397	TUNNEL, PROPELLOR SHAFT, LEFT		1	8	FV59177	
30	LV9ASC/2510-99-815-6398	TUNNEL, PROPELLOR SHAFT, LEFT		1			
31	G1/5310-99-941-8634	WASHER, FLAT	steel, zinc coated, 1/4 in.	20			} Tunnel to hull
32	G1/5310-99-941-3524	NUT, SELF-LOCKING, HEXAGON	UNF, steel, nylon insert, zinc coated, 1/4 in.	20			
33	LV9ASC/2510-99-815-6390	FLOOR, FALSE, DRIVERS		1	9	FV59024	} Drivers floor plate to hull
34	G1/5310-99-943-8479	WASHER, LOCK	steel, int, flat, zinc coated, 1/4 in.	5			
35	G1/5305-99-941-7062	SCREW, MACHINE	UNF, steel, hex hd, zinc coated, 1/4 in. x 3/8 in.	3			
36	LV9ASC/2510-99-815-6400	FLOOR PLATE, HULL, LEFT		1	11	FV59174	} Early type bodier
37	LV9ASC/5305-99-815-6225	SCREW, SET	UNF, steel, hex hd, dog point, Cd plated, 1/4 in. x 3/4 in.	10			
38	LV9ASC/2510-99-815-6383	TREAD, METALLIC, NONSKID	rh	1	10	FV58397	
39	LV9ASC/2510-99-815-6382	TREAD, METALLIC, NONSKID	lh	1	11	FV58396	
40	G1/5310-99-941-8634	WASHER, FLAT	steel, int, flat, zinc coated, 1/4 in.	10			
41	G1/5305-99-941-6543	SCREW, MACHINE	UNF, steel, hex hd, zinc coated, 1/4 in. x 3/4 in.	10			
42	LV9ASC/2520-99-815-6403	COVER, PLATE, ACCESS		1	12	FV59179	} w/T carrier to brackets
43	G1/5310-99-941-8386	WASHER, FLAT	steel, zinc coated, 5/16 in.	2			
44	G1/5305-99-941-6546	SCREW, MACHINE	UNF, steel, hex hd, zinc coated, 5/16 in. x 3/4 in.	2			} Transmission cover
45	G1/XUS3055R	SCREW, MACHINE	UNF, steel csk hd, slotted, zinc coated, 5/16 in. x 5/8 in.	2			

Item No.	Catalogue Number	Item Name	Item Description	No. Off	Plate Ref.	Drawing No.	Remarks
1		FLOOR PLATES AND COVERS - Contd				H1	
2	LV9ASC/2520-99-815-6369	COVER, TRANSFER BOX AND MAINSHAFT	rh	1	13	FV58289	Cover to gear case
3	LV9ASC/2520-99-815-6370	COVER, TRANSFER BOX AND MAINSHAFT	lh	1	14	FV58291	
4	G1/5305-99-941-0696	SCREW, MACHINE	UNC, steel, hex hd, zinc coated, 5/16 in. x 1/2 in.	2			Covers to front supports
5	G1/GA19171	WASHER, LOCK	steel, int, flat, zinc coated, 5/16 in.	4			
6	G1/5305-99-941-7063	SCREW, MACHINE	UNF, steel, hex hd, zinc coated, 5/16 in. x 1/2 in.	2			Covers to seat and top rail
7	G1/5310-99-943-8479	WASHER, LOCK	steel, int, flat, zinc coated, 1/4 in.	4			
8	G1/5305-99-941-6284	SCREW, MACHINE	UNF, steel, hex hd, zinc coated, 1/4 in. x 1/2 in.	4			Front plate to gear case
9	LV9ASC/2520-99-815-6371	COVER, TRANSFER BOX, CENTRE	steel, int. flat, zinc coated, 5/16 in.	1	15	FV58293	
10	G1/GA19171	WASHER, LOCK	steel, int. flat, zinc coated, 5/16 in.	4			Front support to gear case
11	G1/5305-99-941-6546	SCREW, MACHINE	UNF steel, hex hd, zinc coated, 5/16 in. x 3/4 in.	4			
12	LV9ASC/2510-99-815-6401	SUPPORT ASSEMBLY, FRONT	steel, int, flat, zinc coated, 5/16 in.	1	16	FV59175	Front support to gear case
13	G1/GA19171	WASHER, LOCK	steel, int, flat, zinc coated, 5/16 in.	2			
14	G1/5305-99-941-7060	SCREW, MACHINE	UNC, steel, hex hd, zinc coated, 5/16 in. x 5/8 in.	2			Rear support to gear case
15	LV9ASC/2510-99-815-6402	REAR SUPPORT AND CABLE TRAY ASSEMBLY	steel, int, flat, zinc coated, 5/16 in.	1	17	FV59177	
16	G1/GA19171	WASHER, LOCK	steel, int, flat, zinc coated, 5/16 in.	4			Rear support to gear case
17	G1/5305-99-941-0700	SCREW, MACHINE	UNC, steel, hex hd, zinc coated, 5/16 in. x 1 in.	4			
18							
19							
20	NP	WINGS AND FITTINGS - REAR WING ASSEMBLY					
21	LV9ASC/2510-99-804-3452	MUDGUARD, VEHICULAR	lh	1	18	FV542128	Platform assembly to mudguard
22	LV9ASC/2510-99-804-3454	STAY, VEHICLE MUDGUARD	forward	1		FV542124	
23	LV9ASC/2510-99-804-3455	STAY, VEHICLE MUDGUARD	upper	2		FV58073	
24	LV9ASC/2540-99-802-6405	DEE PIECE	steel, 1/4 in. dia x 2 in. lg	8		FV52736	
25							
26	NP	REAR WING ASSEMBLY					
27	LV9ASC/2510-99-804-3453	MUDGUARD, VEHICULAR	rh	1	19	FV542129	Platform assembly to mudguard
28	LV9ASC/2510-99-804-3454	STAY, VEHICLE MUDGUARD	forward	1		FV542125	
29	LV9ASC/2510-99-804-3455	STAY, VEHICLE MUDGUARD	upper	2		FV58078	
30	LV9ASC/2510-99-804-3456	STAY, VEHICLE MUDGUARD	rear	1		FV58073	
31	LV9ASC/2540-99-802-6405	DEE PIECE	steel, 1/4 in. dia x 2 in. lg	4		FV58079	Mudguard to hull
32						FV52736	
33	NP	FRONT WING ASSEMBLY					
34	LV9ASC/2510-99-804-3402	MUDGUARD VEHICULAR	rh	1	20	FV542131	Platform assembly to mudguard
35	LV9ASC/2510-99-804-3403	STAY, VEHICLE MUDGUARD	forward	1		FV542127	
36	LV9ASC/2510-99-804-3404	STAY, VEHICLE MUDGUARD	centre	1		FV58210	
37	LV9ASC/2510-99-804-3455	STAY, VEHICLE MUDGUARD	upper	1		FV58207	
38	LV9ASC/2510-99-804-3405	STAY, VEHICLE MUDGUARD	lower	1		FV58073	Mudguard to hull
39	LV9ASC/2510-99-804-3406	PLATFORM ASSEMBLY, HEADLAMP		1		FV58074	
40							
41	NP	FRONT WING ASSEMBLY					
42	LV9ASC/2510-99-804-3451	MUDGUARD VEHICULAR	lh	1	21	FV542130	Platform assembly to mudguard
43	LV9ASC/2510-99-804-3455	STAY, VEHICLE MUDGUARD	upper	1		FV542126	
44	LV9ASC/2510-99-804-3406	PLATFORM ASSEMBLY, HEADLAMP		1		FV58073	
45	G1/5310-99-941-8685	WASHER, FLAT	steel, zinc coated, 3/8 in.	11		FV55469	
46	G1/5310-99-943-4299	NUT, SELF-LOCKING HEXAGON	UNF, steel, nylon insert, thick, zinc coated, 3/8 in.	11			Platform assembly to mudguard
47	G1/5310-99-941-8386	WASHER, FLAT	steel, zinc coated, 5/16 in.	39			
48	G1/5310-99-941-3525	NUT, SELF-LOCKING HEXAGON	UNF, steel, nylon, thick, zinc coated, 5/16 in.	39			Mudguard to hull
49	LV6MT3/2540-99-803-0704	MIRROR ASSEMBLY, REAR VIEW	rh	1		FV58368	
50	LV6MT3/44106	MIRROR, OBLONG, CONVEX		1			Mirrors to front wings
51	LV6MT3/2540-99-803-0703	MIRROR ASSEMBLY, REAR VIEW	lh	1		FV58369	
52	LV6MT3/44106	MIRROR OBLONG, CONVEX		1			Mirrors to front wings
53	G1/5305-99-941-6535	SCREW, MACHINE	UNF, steel, csk hd, zinc coated, 1/4 in. x 3/4 in.	4			
54	G1/5310-99-941-3524	NUT, SELF-LOCKING, HEXAGON	UNF, steel, nylon insert, zinc coated, 1/4 in.	4			Mirrors to front wings
55							
56							
57	LV9ASC/FV51594	ROOF COVER AND FITTINGS - COVER, ROOF		1			Mk 1 & 1/1
58	NP	COVER, CANVAS		1		FV59318	
59	H2/HB0342	CANVAS	white, 40 in.	1			Mk 1 & 1/1
60	G1/GA15108	EYELET	brass, size B	1			
61	H2/4020-99-942-5027	ROPE	manilla, 1 in.	1			

Item No.	Catalogue Number	Item Name	Item Description	No. Off	Plate Ref.	Drawing No.	Remarks
1		ROOF COVER AND FITTINGS -Contd					
2	LV9ASC/2510-99-815-6380	PLATE ASSEMBLY, HULL ROOF	front	1		FV58383	} Roof plates to hull
3	LV9ASC/2510-99-815-6381	PLATE, HULL ROOF	rear	1		FV58386	
4	G1/5306-99-941-0313	BOLT, MACHINE	UNF, steel, hex h., zinc coated, 3/8 in. x 1-1/2 in.	2			
5	G1/5305-99-941-0541	SCREW, MACHINE	UNF, steel, hex hd, zinc coated, 3/8 in. x 1 in.	10			
6	G1/5310-99-120-2521	WASHER, LOCK	steel, int, flat, zinc coated, 3/8 in.	12			
7	LV9ASC/FV51522	STRIP, SEALING, FRONT		4			
8	LV9ASC/FV51524	STRIP, SEALING, SIDE		2			
9	LV9ASC/FV51526	STRIP, SEALING, REAR LIGHT		1			
10	LV9ASC/FV51527	STRIP, SEALING, REAR LEFT		1			
11	LV9ASC/FV51529	STRIP, SEALING, REAR CENTRE		2			
12	G1/5310-99-120-2521	WASHER, LOCK	steel, int, flat, zinc coated, 3/8 in.	18			} Sealing strips to hull
13	G1/5310-99-941-0915	NUT, PLAIN, HEXAGON	UNF, steel, hex hd, zinc coated, 3/8 in.	18			
14	LV9ASC/2510-99-815-6289	BRACKET ASSEMBLY, SUPPORT, CANVAS ROOF		2		FV51515	} Support brackets to hull
15	G1/5310-99-120-2521	WASHER, LOCK	steel, int, flat, zinc coated, 3/8 in.	4			
16	G1/5305-99-941-6181	SCREW, MACHINE	UNF, steel, csk hex hd, zinc coated, 3/8 in. x 1 in.	4			
17	LV9ASC/2510-99-815-6287	SUPPORT ASSEMBLY, CANVAS ROOF		1		FV51510	
18	LV9ASC/2510-99-815-6288	SUPPORT AND RING ASSEMBLY, CANVAS ROOF		1		FV51514	
19					H3		
20					1-28	FV59512	
21	NP	SEAT, DRIVERS		1			
22	LV6MT1 3/2540-99-808-8026	SEAT, INDIVIDUAL	w/o backrest	1			
23	LV6MT1 3/2540-99-808-8027	BACK REST, INDIVIDUAL SEAT	adjustable	1			
24	LV6MT1 3/2540-99-808-8024	BACK REST, INDIVIDUAL SEAT	cushion	1	1		
25	LV6MT1 3/2540-99-808-8025	CUSHION, SEAT, VEHICULAR		1	4		
26	LV6MT1 3/CHRX7676	RAIL, FLOOR, RATCHET		1	5		
27	LV6MT1 3/CHRX7677	RAIL, FLOOR, PLAIN		1	7		
28	LV6MT1 3/CHN6236	SPINDLE, VERTICAL, ADJUSTMENT		1	12		
29	LV6MT1 3/CHN6226	TUBE, SEAT, VERTICAL		1	14		
30	G1/5305-99-941-0513	SCREW, MACHINE	UNF, steel, hex hd, zinc coated, 1/4 in. x 3/4 in.	4	15		
31	G1/5310-99-941-3524	NUT, SELF-LOCKING, HEXAGON	UNF, steel, nylon insert, zinc coated, 1/4 in.	4	16		
32	G1/5305-99-941-1883	SCREW, MACHINE	UNF, steel, fillister hd, zinc coated, 1/4 in. x 1/2 in.	5	21		
33	G1/5310-99-943-8479	WASHER, LOCK	steel, int, flat, zinc coated, 1/4 in.	4	22		} Pan to seat
34	G1/5310-99-941-0924	NUT, PLAIN, HEXAGON	UNF, steel, zinc coated, 1/4 in.	4	23		
35	LV6MT1 3/2540-99-808-7150	LEVER, ADJUSTING, VEHICULAR SEAT		1	24		
36	LV6MT1 3/2540-99-808-7087	SPRING, HELICAL, COMPRESSION	adjusting lever	1	25		
37	G1/5305-99-941-1885	SCREW, MACHINE	UNF, steel, fillister hd, zinc coated, 1/4 in. x 3/4 in.	1	27		} Lever to slide
38	G1/5310-99-941-3524	NUT, SELF-LOCKING, HEXAGON	UNF, steel, nylon insert, zinc coated, 1/4 in.	1	28		
39	G1/5310-99-941-3523	NUT, SELF-LOCKING, HEXAGON	UNF, steel, nylon insert, zinc coated, 5/16 in.	4			} Drivers seat to floor
40					H4		
41	LV9ASC/2540-99-815-7264	SEAT, INDIVIDUAL	gunners	1	1-36	FV59458	
42	LV6MT1 3/CHNY14825	RAIL, FLOOR		2	1		
43	LV6MT1 3/CHNY7262	CHANNEL, SLIDE		2	9		
44	LV6MT1 3/CHNZ7271	SPINNER, NUT AND TUBE		1	12		
45	LV6MT1 3/CHNZ6777	SPINDLE, VERTICAL, SEAT ADJUSTMENT		1	13		
46	LV6MT1 3/2540-99-808-7159	LEVER, CONTROL, HAND		1	14		
47	LV6MT1 3/2540-99-808-7087	SPRING, HELICAL, COMPRESSION	adjusting lever	1	15		
48	G1/5305-99-941-1885	SCREW, MACHINE	UNF, steel, fillister hd, zinc coated, 1/4 in. x 3/4 in.	1	16		} Lever to slide
49	G1/5310-99-941-3524	NUT, SELF-LOCKING, HEXAGON	UNF, steel, nylon insert, zinc coated, 1/4 in.	1	17		
50	LV6MT1 3/CHNZ12726	CATCH, SPINNER		1	22		

Item No.	Catalogue Number	Item Name	Item Description	No. Off	Plate Ref.	Drawing No.	Remarks
1					H4		
2		SEAT, INDIVIDUAL - Contd					
3	G1/5305-99-941-1882	SCREW, MACHINE	UNF, steel, fillister hd, zinc coated, 1/4 in. x 3/8 in.	2) Spinner bracket to seat frame
4	LV6:MT13/5510-99-941-5524	NUT, SELF-LOCKING, HEXAGON	UNF, steel, nylon insert, zinc coated, 1/4 in.	2)
5	LV6:MT13/2540-99-808-7165	SPRING, HELICAL, TORSION		1	24)Spinner
6	G1/5310-99-941-9351	WASHER, LOCK	steel, int, flat, BA, no. 3	1)spring to
7	G1/5305-99-941-6854	SCREW, MACHINE	BA, steel, rd hd, Cd plated, no. 4 x 1/2 in.	1)lever
8	G1/5305-99-941-1751	SCREW, MACHINE	UNF, steel, csk hd, slotted, zinc coated, 1/4 in. x 7/8 in.	2)
9	G1/5310-99-941-3524	NUT, SELF-LOCKING, HEXAGON	UNF, steel, nylon insert, zinc coated, 1/4 in.	2) Stop to seat frame
10	G1/5305-99-941-1751	SCREW, MACHINE	UNF, steel, csk hd, slotted, zinc coated, 1/4 in. x 7/8 in.	4)
11	G1/5310-99-941-3524	NUT, SELF-LOCKING, HEXAGON	UNF, steel, nylon insert, zinc coated, 1/4 in.	4)High bracket to cross-member
12	G1/5310-99-941-0902	NUT, PLAIN, HEXAGON	UNF, steel, lock, zinc coated, 1/4 in.	1	28) Connecting rod
13	LV6:MT13/2540-99-808-7169	SPRING, HELICAL, EXTENSION	centre	1	30		
14	LV6:MT13/2540-99-808-7089	SPRING, HELICAL, EXTENSION		2	32		
15	G1/5315-99-942-3568	PIN, GROOVED, HEADLESS	steel, GP1, phosphated, 1/8 in. dia x 1-1/8 in. lg	1			
16	G1/5310-99-941-3524	NUT, SELF-LOCKING, HEXAGON	UNF, steel, nylon insert, zinc coated, 1/4 in.	2			
17	LV6:MT13/2540-99-808-7227	SPRING, HELICAL, EXTENSION	main left front	1	33		
18	LV6:MT13/2540-99-808-7228	SPRING, MAIN LEFT, GUNNERS SEAT, REAR		1	34		
19	G1/5315-99-942-3565	PIN, GROOVED, HEADLESS	steel, GP1, phosphated, 1/8 in. dia x 3/4 in. lg	2) Bracket to block
20	LV6:MT13/CHRY7317	CUSHION, GUNNERS SEAT			35		
21	G1/5305-99-941-5298	SCREW, MACHINE	UNF, steel, csk hd, slotted, zinc coated, 1/4 in. x 5/8 in.	4) Gunners seat to rail
22		BASE PLATE ASSEMBLY		2		FV857466	
23	G1/5310-99-101-3187	WASHER, LOCK	steel, int, flat, zinc coated, 5/16 in.	4			
24	G1/5305-99-941-3696	SCREW, MACHINE	UNF, steel, hex hd, zinc coated, 5/16 in. x 1/2 in.	4			
25	LV9ASC/2540-99-815-7248	BRACKET ASSEMBLY, SEAT SUPPORT	rh	2		FV55516	
26	LV9ASC/2540-99-815-7249	BRACKET ASSEMBLY, SEAT SUPPORT	lh	2		FV55517	
27	G1/5310-99-120-2521	WASHER, LOCK	steel, int, flat, zinc coated, 3/8 in.	8) Brackets to escape door
28	G1/5310-99-941-0915	NUT, PLAIN, HEXAGON	UNF, steel, zinc coated, 3/8 in.	3)
29	LV9ASC/2540-99-815-7263	SEAT, INDIVIDUAL	gunner's side	2) Mk 1 and
30	LV9ASC/2540-99-815-7255	CUSHION, SEAT, VEHICULAR		2) Mk 1/1
31	G1/5320-99-433-2437	RIVET, SOLID	steel, boss hd, 1/4 in. dia x 1-1/4 in. lg	4			
32	LV9ASC/5315-99-815-7238	PIN, STRAIGHT, HEADED	steel, phosphated, 1/2 in. dia x 51/64 in. lg	4		FV51432	
33	G1/5315-99-944-0177	PIN, COTTER, SPLIT	steel, phosphated, 3/32 in. dia x 1 in. lg	4			
34	LV9ASC/2540-99-815-7237	CLIP, SEAT, SIDE GUNNERS		4		FV51425	
35	G1/5310-99-943-8479	WASHER, LOCK	steel, int, flat, zinc coated, 1/4 in.	4) Clip to escape door
36	G1/5310-99-941-0913	NUT, PLAIN, HEXAGON	UNF, steel, zinc coated, 1/4 in.	4)
37					H5		
38	LV6:MT13/2540-99-817-1706	SEAT, INDIVIDUAL		1	1-45	44250) Mallam Sleigh and Cheston
39	LV6:MT13/2540-99-817-6742	SLIDE, OUTER, SEAT INDIVIDUAL	1.25 in. w x 8.7 in. lg x 0.5 in. h	2	1	44256)
40	LV6:MT13/2540-99-817-6741	SLIDE, INNER, SEAT INDIVIDUAL	9.1 in. w x 15.25 in. lg x 1.2 in. h	1	2	44251)
41	G1/5305-99-941-0512	SCREW, MACHINE	UNF, steel, hex hd, zinc coated, 1/4 in. x 5/8 in. lg	6	4) Alternative to FV59458 on Mk 4
42	G1/5306-99-941-0224	BOLT, MACHINE	UNF, steel, hex hd, zinc coated, 1/4 in. x 1-1/2 in. lg	2	5)

Item No.	Catalogue Number	Item Name	Item Description	No. Off	Plate Ref.	Drawing No.	Remarks
1		SEAT, INDIVIDUAL - Contd			H5		
2		WASHER, FLAT	steel, zinc coated, 1/4 in.	8	6)
3	G1/5310-99-941-8634		UNF, steel, zinc coated,	3	7)
4	G1/5310-99-941-0924	NUT, FLAIN, HEXAGON	1/4 in.	3	7)
5	G1/5310-99-941-8635	WASHER, FLAT	steel, zinc coated, 3/8 in.	12	11)
6	LV6MT1/5360-99-817-6743	SPRING, HELICAL, EXTENSION	steel, 0.75 in. od x 4.533 in. free lg, hook ends	2	15	44268)
7	LV6MT13/5335-99-817-6746	KNOB	plastics, push on type, rd shape	1	18	43365)
8	G1/5310-99-941-8386	WASHER, FLAT	steel, zinc coated, 5/16 in.	8)
9	LV6MT1/5360-99-817-6744	SPRING, HELICAL, EXTENSION	steel, 0.913 in. od x 10.663 in. free lg, hook ends	2	25	44280)Alternative
10	NP	SHAFT, ASSEMBLY		1	26-28	44656)to FV59458
11		BRACKET		1	27	44281)on 13: 4
12		SCREW		1	28)
13	LV6MT13/5335-99-817-6737	KNOB	plastics, screw on type, rd shape	1	35	40347)
14	LV6MT13/2540-99-817-6745	CUSHION, SEAT, VEHICULAR	black trim, board mtg, 4 fixing nuts	1	42	44292)
15	G1/5306-99-941-0282	BOLT, MACHINE	UNF, steel, hex hd, zinc coated, 1/4 in. x 1-1/4 in. lg	4	43)
16	LV9ASC/2540-99-829-0695	HARNES, SAFETY, VEHICULAR	seat harness, commander	1		FV857460)
17	LV9ASC/2540-99-825-0217	BELT, AUTOMOBILE, SAFETY	webbing belt and buckle attachment	1		FV759447)

BODY AND FLOOR PLATES

HI

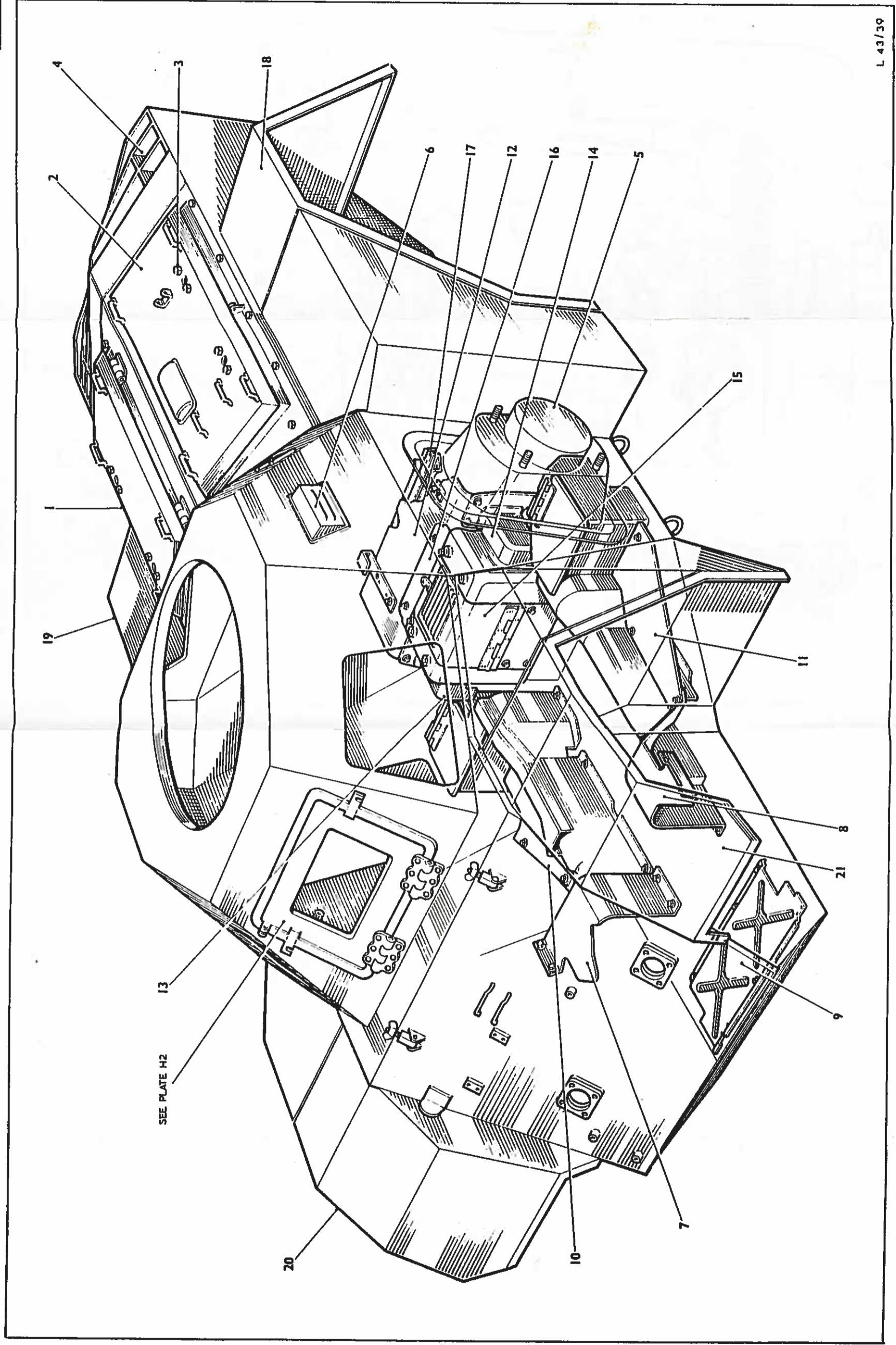

DRIVER'S HATCH AND VISOR

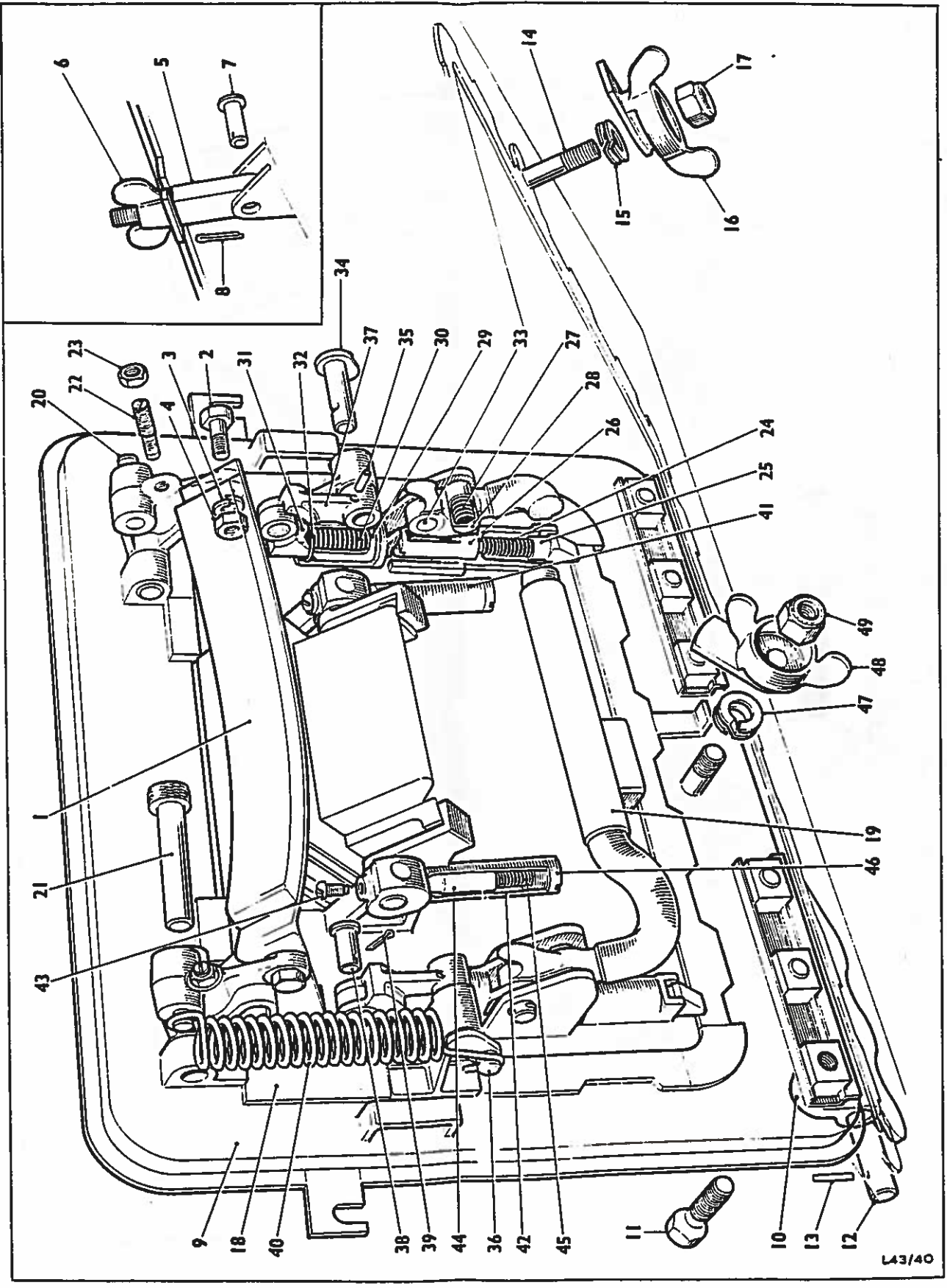

DRIVER'S SEAT

H3

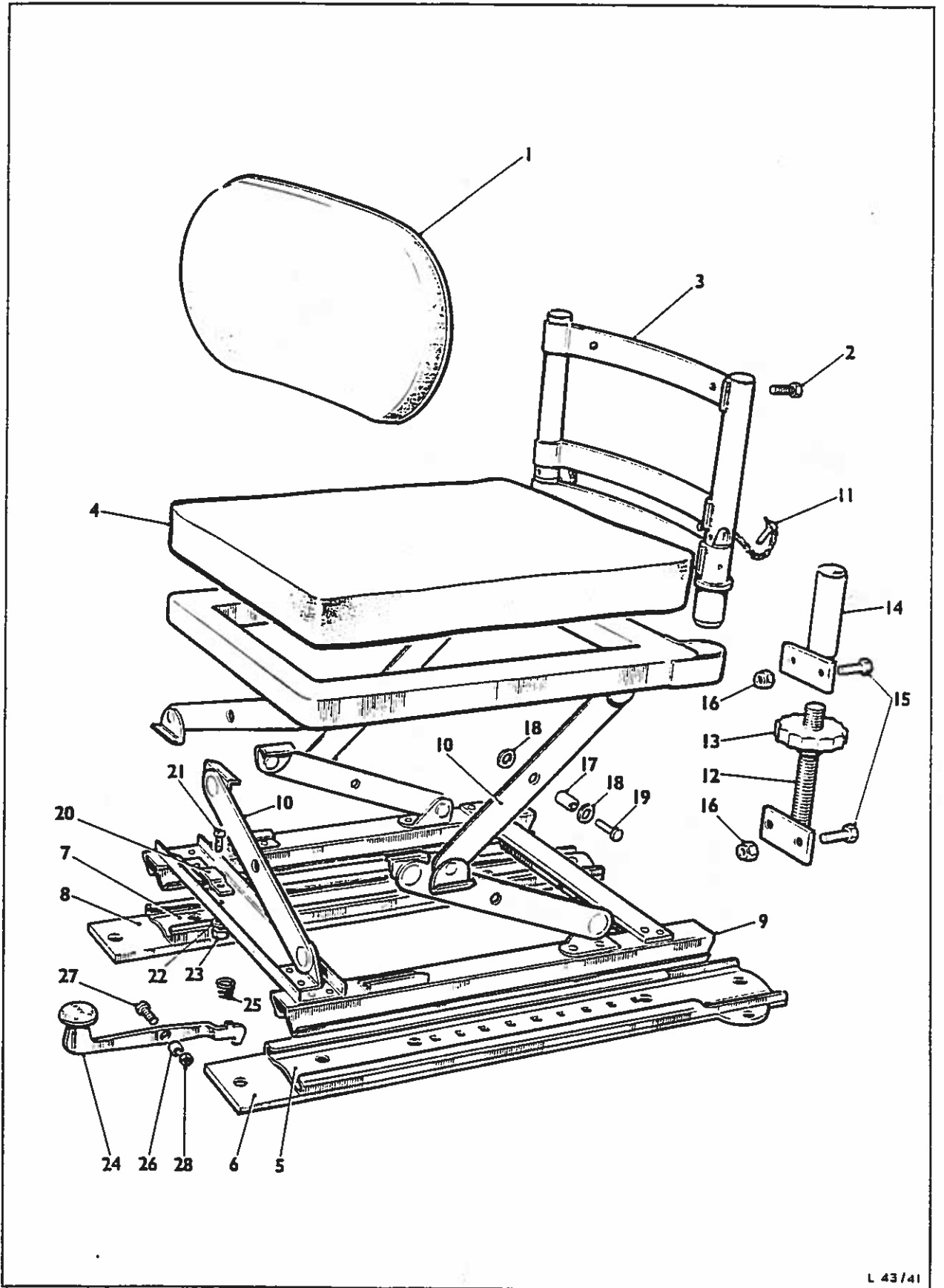

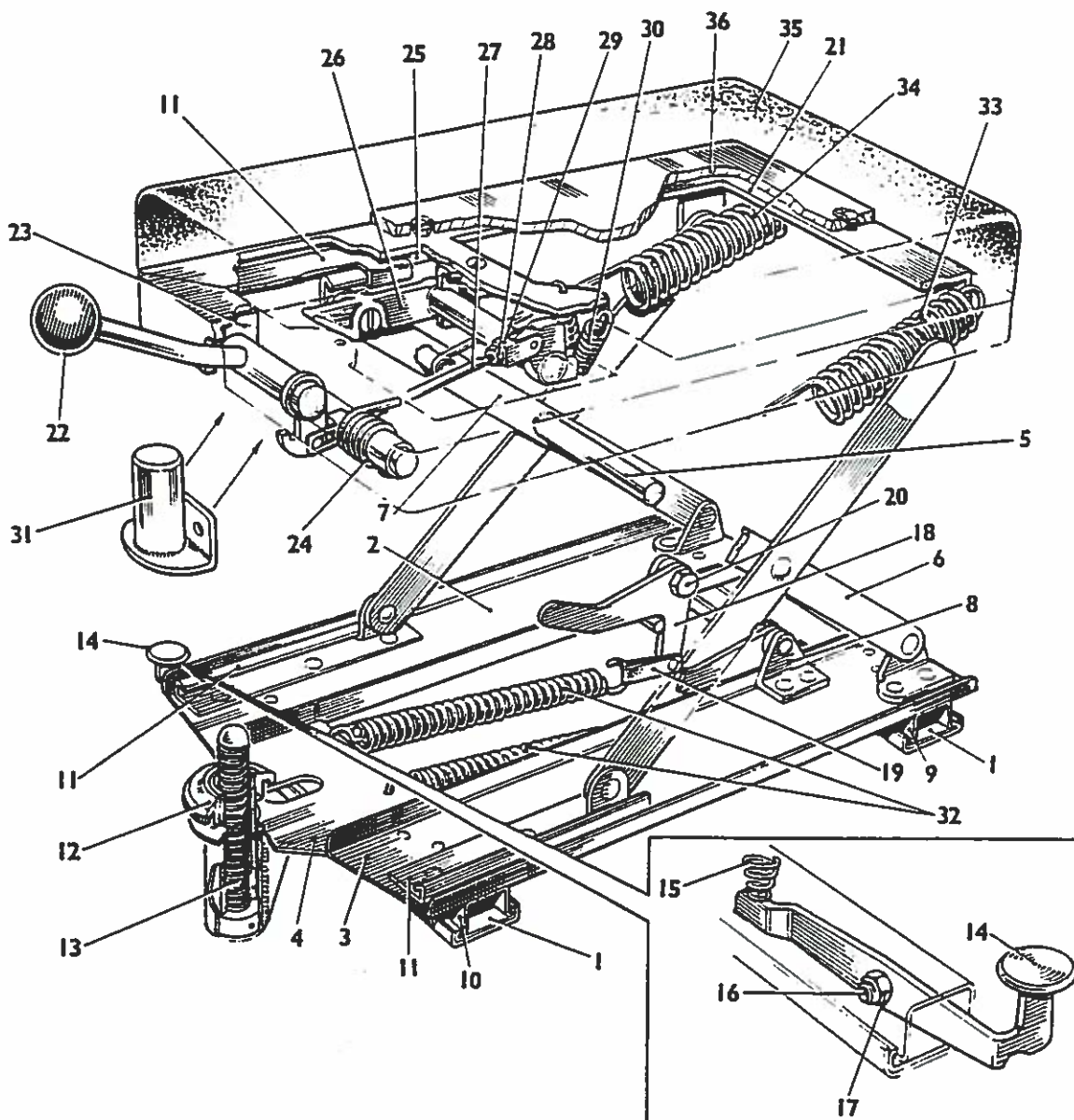

GUNNER'S SEAT

H5

