

GROUP
B
COOLANT SYSTEM

COOLANT SYSTEM

CONTENTS

	Page
CENTRIFUGAL PUMP	B3
PAN AND COWL	B2
FAN COWL FITTINGS	B2
RADIATOR AND FITTINGS	B1

LIST OF ILLUSTRATIONS

(NOTE:- THE TEXT DOES NOT NECESSARILY INCLUDE ALL THE ITEMS REFERENCE)

	Plate
COOLANT PUMP	B3
PAN AND COWL	B2
RADIATOR AND FITTINGS	B1

Item No.	Catalogue Number	Item Name	Item Description	No. Off	Plate Ref.	Drawing No.	Remarks
1		RADIATOR AND FITTINGS -					
2	LV9ASC/2930-99-815-7693	RADIATOR, ENGINE COOLANT		1	1-4	FV59086	
3	NP	RADIATOR		1	1-3	FV11300	
4	LV6MT1/2930-99-800-7916	VALVE ASSEMBLY, RADIATOR		1	2	FV494851	
5	X3/2815-99-200-3872	GASKET	pressure valve	1	3	AC/1571548	} Valve flange
6	Z2/5310-99-941-7070	NUT, PLAIN, HEXAGON	BA, steel, Cd plated, no. 2	6			
7	G1/5310-99-941-6653	WASHER, LOCK	steel, single coil, sq section, Cd plated, 3/16 in.				
8	LV6MT1/11456	FELT	rot-proofed, extra hard, 3/8 in.	6			
9	LV9ASC/2930-99-815-7656	BRACKET, RADIATOR SUPPORT		as req	4		
10	LV6MT1/902LB	FELT	rot-proofed, extra hard, 1/4 in.	2	5-6	FV50344	
11	LV9ASC/5330-99-815-7093	GASKET		as req	6		
12	G1/5305-99-941-9712	SCREW, MACHINE	radiator support cracket	2		FV51989	
13	G1/5310-99-120-2521	WASHER, LOCK	UNC, steel, hex hd, zinc coated, 3/8 in. x 3/4 in.	4			} Radiator support bracket
14	LV9ASC/2930-99-815-7657	BRACKET, RADIATOR MOUNTING	steel, int, flat, zinc coated, 3/8 in.	4			
15	LV9ASC/2930-99-815-7669	BRACKET, RADIATOR MOUNTING	lh	1	7	FV50347	
16	G1/5305-99-941-0698	SCREW, MACHINE	rh	1	7	FV51580	
17	G1/GA19171	WASHER, LOCK	UNC, steel, hex hd, zinc coated, 5/16 in. x 3/4 in.	4			} Hinge bracket to fan cowl
18	LV9ASC/5306-99-815-7658	EYEBOLT	steel, int, flat, zinc coated, 5/16 in.	4			
19	LV9ASC/2930-99-815-7659	PIN, STRAIGHT, HEADED	radiator mounting	2	8	FV50348	
20	G1/5315-99-942-0378	PIN, COTTER, SPLIT	steel, phosphated, 1/16 in. x 3/4 in.	2	9	FV50349	} Hinge bracket
21	LV9ASC/2930-99-815-7660	SPRING, RADIATOR MOUNTING		2	10	FV50350	
22	G1/5310-99-941-8386	WASHER, FLAT	steel, zinc coated, 5/16 in.	2	11		} Spring retaining
23	G1/5310-99-941-3525	NUT, SELF-LOCKING, HEXAGON	nylon insert, zinc coated, 5/16 in.	2	12		
24	LV9ASC/2930-99-815-7682	RADIATOR PIPE	w/filler cap, top	1	13-15	FV55532	
25	LV9AD/2930-99-811-5864	CAP, FILLER	radiator	1	14	FV52627	
26	G1/GA 15082	CHAIN	brass, solid link, no. 4	as req	15		
27	G1/GA 14230	RING, SPLIT	steel, 3/4 in. dia	2			
28	LV9ASC/2930-99-815-7685	PIPE ASSEMBLY, WATER	bottom	1	16	FV58066	} Fitted up to vehicle No. 33 BAC1
29	LV9ASC/FV58426	PIPE, RADIATOR		1	16		
30	LV6MT6/4720-99-942-7731	HOSE, RUBBER	1-1/4 in. id x 1-5/8 in. od, engine coolant	as req	17		} Brown and yellow stripes
31	LV6MT1/4730-99-942-9610	CLAMP, HOSE	steel, Cd plated, 1-1/2 in. to 2 in.	8	18		
32	LV6MT6/4720-99-942-7727	HOSE, RUBBER	3/4 in. id x 1-1/8 in. od, engine coolant	as req	19	FV50361	} Yellow and brown stripes
33	LV6MT1/4730-99-801-1056	CLAMP, HOSE	steel, Cd plated, 7/8 in. to 1-1/2 in.	2	20		
34	LV6MT1/88504	PLUG	BSP.F, steel, hex hd, 1/4 in.	1	21		
35	LV9ASC/5330-99-815-6327	GASKET	copper, 0.518 in. id	1	22	FV51890	} Plug
36	LV9ASC/2805-99-815-7694	PIPE ASSEMBLY, DRAIN, ENGINE		1	23	FV59115	
37	G2/GB16256	TUBING	steel, seamless, 1/2 in. od x 45 in. lg x 20 SWG	as req			
38	LV6MT1/4730-99-801-1482	NUT, UNION, PIPE	BSP.F, 1/2 in.	2			} Engine drain pipe
39	LV6MT1/37397	NIPPLE	union pipe, single coned, 1/2 in. id	2			
40	LV6MT1/37366	BODY	union pipe, double ended, BSP.F, 1/2 in.	1	24		
41	LV9ASC/5330-99-815-6328	GASKET	copper, 0.825 in. id	1	25	FV51892	} Overflow pipe
42	LV9ASC/2930-99-815-7667	PIPE ASSEMBLY, OVERFLOW		1	25	FV51156	
43	G1/5310-99-941-0897	NUT, PLAIN, HEXAGON	UNF, steel, lock, zinc coated, 5/8 in.	1			
44	G1/GA19175	WASHER, LOCK	steel, int, flat, zinc coated, 5/8 in.	1			

Item No.	Catalogue Number	Item Name	Item Description	No. Off	Plate Ref.	Drawing No.	Remarks
1		RADIATOR AND FITTINGS - Contd					
2	LV6MT6/4720-99-805-7811	HOSE	coolant, 5/16 in. id	as req	27		} Overflow pipe
3	LV6MT1/4730-99-942-9463	CLAMP, HOSE	steel, Cd plated, 5/8 in. to 7/8 in.	4	28		
4	LV6MT1/30594	TUBING	steel, 5/16 in. od x 31 in. lg	as req	29		
5	LV9ASC/5340-99-815-8203	CLAMP, LOOP	steel, overflow pipe	1	30	FV51490	
6		FAN AND COWL					} Fan cowl bracket
7	NP						
8	LV9ASC/2930-99-815-7650	COWL AND FELT ASSEMBLY, FAN		1	1-24	FV59353	}
9	LV6MT1/21526	FELT	rot-proofed, extra hard, 3/16 in.	1	1-3	FV9606	
10	LV6MT1/90247	FELT	rot-proofed, extra hard, 1/8 in.	as req	2		
11	LV9ASC/2930-99-815-7671	SHAFT, FAN		as req	3		}
12	LV6MT1/GOMIS17	SEAL	oil, 1-7/16 in. id x 2-1/4 in. od x 3/8 in.	1	4	FV55088	
13	LV9ASC/2930-99-815-7695	FAN, ENGINE COOLING		1	5		} Fan and fan shaft
14	LV6MT7/3110-99-950-0192	BEARING, PARALLEL ROLLER, JOURNAL	single row, 30 mm id x 62 mm od x 16 mm w	1	6-7	FV59232	
15	LV9ASC/2930-99-815-7651	SPACER, FAN BEARING	small	1	8		}
16	LV9ASC/2930-99-815-7652	SPACER, FAN BEARING	large	1	9	FV50182	
17	LV6MT7/3110-99-950-0246	BEARING, PARALLEL ROLLER, JOURNAL	single row, 30 mm id x 62 mm od x 16 mm w	1	10	FV50183	
18	LV9ASC/5306-99-815-7666	BOLT, SHOULDER	UNF, steel, phosphated, 3/8 in. x 4-1/4 in.	1	11		}
19	G1/5310-99-941-1254	NUT, SLOTTED, HEXAGON	UNF, steel, Cd plated, 3/8 in.	1	12	FV51118	
20	G1/5315-99-942-0379	PIN, COTTER, SPLIT	steel, phosphated, 1/16 in. x 5/8 in.	1	13		} Retaining bolt
21	LV9ASC/2930-99-815-7653	WASHER, TAB	two holes	1	14	FV50186	
22	G1/5305-99-941-0524	SCREW, MACHINE	UNF, steel, hex hd, zinc coated, 5/16 in. x 5/8 in.	2	14		} Fan hub
23	LV9ASC/2930-99-815-7672	HUB, FAN		4	15	FV55090	
24	LV9ASC/2930-99-815-7675	COUPLING, SHAFT, FLEXIBLE		1	16	FV55095	}
25	G1/5305-99-941-0301	BOLT, MACHINE	UNF, steel, hex hd, zinc coated, 5/16 in. x 2 in.	2	17		
26	G1/5310-99-941-3525	NUT, SELF-LOCKING, HEXAGON	UNF, nylon insert, zinc coated, 5/16 in.	2	17		} Fan to coupling
27	LV9ASC/2930-99-815-7673	COUPLING ASSEMBLY		2	18		
28	G1/5305-99-941-0300	BOLT, MACHINE	UNF, steel, hex hd, zinc coated, 5/16 in. x 1-3/4 in.	1	19	FV55091	}
29	G1/5310-99-941-8386	WASHER, FLAT	steel, zinc coated, 5/16 in.	2	19		
30	G1/5310-99-941-3525	NUT, SELF-LOCKING, HEXAGON	UNF, nylon insert, zinc coated, 5/16 in.	6	19		} Flexible coupling
31	LV9ASC/2930-99-815-7675	COUPLING, SHAFT, FLEXIBLE		2	20	FV55095	
32	G1/5305-99-941-0300	BOLT, MACHINE	UNF, steel, hex hd, zinc coated, 5/16 in. x 1-3/4 in.	1	20		}
33	G1/5310-99-941-8386	NUT, SELF-LOCKING, HEXAGON	UNF, nylon insert, zinc coated, 5/16 in.	2	21		
34	G1/5305-99-941-0524	SCREW, MACHINE	UNF, steel, hex hd, zinc coated, 5/16 in. x 5/8 in.	2	22		}
35	G1/GA 19171	WASHER, LOCK	steel, int, flat, zinc coated, 5/16 in.	6	23		
36				6	24		} Shaft to cowl
37				6	24		
38	LV9ASC/2930-99-815-7674	FAN COWL FITTINGS -					}
39	G1/5305-99-941-0297	FLANGE, COUPLING, WATER PUMP BOLT, MACHINE	UNF, steel, hex hd, zinc coated, 5/16 in. x 1-1/4 in.	1	31	FV55094	
40	G1/5310-99-941-3525	NUT, SELF-LOCKING, HEXAGON	UNF, steel, nylon insert, zinc coated, 5/16 in.	2	31		} Water pump flange to fan coupling
41	G1/5310-99-941-8386	WASHER, FLAT	steel, zinc coated, 5/16 in.	2	31		
42	G1/5305-99-941-0715	SCREW, MACHINE	UNC, steel, hex hd, zinc coated, 3/8 in. x 1-1/8 in.	2	31		}
43	G1/5310-99-120-2521	WASHER, LOCK	steel, int, flat, zinc coated, 3/8 in.	6	31		
44	LV9ASC/FV58179	PLATE, ANGLE	side shield, lh	1	32		} Fan cowl to oil tank
45	LV9ASC/2930-99-815-7686	PLATE, ANGLE	side shield, rh	1	33	FV58177	
46	LV9ASC/2930-99-815-6453	SHIELD AND FELT ASSEMBLY, FAN COWL	lh	1	35-36	FV58691	

Item No.	Catalogue Number	Item Name	Item Description	No. Off	Plate Ref.	Drawing No.	Remarks
1		FAN COWL FITTINGS - Contd				B1	
2	LV9ASC/2930-99-815-6453	SHIELD AND FELT ASSEMBLY, FAN COWL - Contd					
3	LV6MT1/9024B	FELT	rot-proofed, extra hard, 1/4 in.	as req	36		
4	LV9ASC/2930-99-815-6455	SHIELD AND FELT ASSEMBLY, FAN COWL,					
5	LV6MT1/9024B	FELT	rh rot-proofed, extra hard, 1/4 in.	1	36-37	FV58694	
6	G1/5305-99-941-0698	SCREW, MACHINE	UNC, steel, hex hd, zinc coated, 5/16 in. x 3/4 in.	as req	37		
7	G1/GA19171	WASHER, LOCK	steel, 5/16 in.	4			Angle to cowl
8	G1/5305-99-941-0510	SCREW, MACHINE	UNF, steel, hex hd, zinc coated, 1/4 in. x 3/8 in.	4			Shield to angle
9	G1/5310-99-943-8479	WASHER, LOCK	steel, int, flat, zinc coated, 1/4 in.	6			
10	G1/5310-99-941-0924	NUT, PLAIN, HEXAGON	UNF, steel, zinc coated, 1/4 in.	6			
11	LV6MT6/4720-99-942-7727	HOSE, RUBBER	3/4 in. id x 1-1/8 in. od	6			
12	LV9ASC/2930-99-815-8204	SECURING STRIP	rubber hose	as req	38		
13	G1/5310-99-943-8479	WASHER, LOCK	steel, int, flat, zinc coated, 1/4 in.	1	39	FV50944	Radiator baffle
14	G1/5310-99-941-0913	NUT, PLAIN, HEXAGON	UNF, steel, zinc coated, 1/4 in.	4			
15	LV9ASC/5340-99-815-7654	BRACKET, ANGLE	radiator stay anchor	4	40		
16	G1/5305-99-941-0697	SCREW, MACHINE	UNC, steel, hex hd, zinc coated, 5/16 in. x 5/8 in.	1	41	FV50337	Bracket to cowl
17	G1/GA19171	WASHER, LOCK	steel, int, flat, zinc coated, 5/16 in.	2	42		
18	LV9ASC/2930-99-815-7680	STEADY, FAN, COWL		2	43	FV55402	
19	LV9ASC/5306-99-815-7655	EYEBOLT	adjusting, radiator steady	1	44	FV50340	
20	G1/5305-99-941-0523	SCREW, MACHINE	UNF, steel, hex hd, zinc coated, 5/16 in. x 1/2 in.	2	45		Radiator steady
21	G1/GA19171	WASHER, LOCK	steel, int, flat, zinc coated, 5/16 in.	2			
22	G1/5310-99-941-0892	NUT, PLAIN, HEXAGON	UNF, steel, lock, zinc coated, 5/16 in.	1	46		
23				1	83		
24	LV10/2930-99-865-4695	PUMP, CENTRIFUGAL	coolant	1	1-23	FV144506	
25	LV10/2930-99-865-4686	CASING CENTRIFUGAL PUMP	coolant	1	1	FV144562	
26	LV6MT1/5330-99-801-6390	SEAL, PLAIN, ENCASED	0.750 in. id x 1.375 in. od x 0.250 in. w	1	2		Rear
27	LV6MT7/3110-99-806-0626	BEARING, ROLLER, JOURNAL	single row, 22 mm x 40 mm x 12 mm	1	3		Less inner race bearing
28	LV6MT1/5340-99-910-8329	RING, RETAINING	steel, int, 40 mm	1	4		
29	LV10/2930-99-865-4696	SHAFT, SHOULDERED	rotor	1	5	FV144604	
30	LV6MT1/5330-99-801-6552	SEAL, PLAIN, ENCASED	1.250 in. id x 1.753 in. od x 0.250 in. w	1	6		Front
31	LV10/2930-99-865-4663	HOUSING, SEAL, ROTARY PUMP	front	1	7	FV142148	
32	LV6MT7/3110-99-950-0054	BEARING, BALL, JOURNAL	single row, 25 mm id x 52 mm od x 15 mm w, '00' fit	1	8		Front bearing
33	LV6MT1/5340-99-910-8242	RING, RETAINING	steel, ext, 25 mm	1	9		Front bearing
34	G1/5310-99-944-0548	WASHER, LOCK	steel, single coil, sq section Cd plated, 1/4 in.	1	10		Oil seal housing
35	LV10/5306-99-865-4562	BOLT, MACHINE	UNF, steel, hex hd, Cd plated, 1/4 in. x 1-1/8 in.	4			
36	LV10/5330-99-865-4690	RING, SEALING, TOROIDAL	synthetic rubber, 0.875 in. id	4	11	RR/UA2553/2	
37	LV10/2930-99-865-4689	RING, WEARING	stationary seal	1	12	FV144575	Cover
38	LV10/2930-99-865-4688	RETAINER, OIL SEAL	rotary	1	13	FV144574	
39	LV10/5330-99-865-4691	RING, SEALING, TOROIDAL	synthetic rubber, 0.625 in. id	1	14	FV144573	
40	LV10/2930-99-865-4713	SPRING, HELICAL, COMPRESSION	pump seal	1	15	FV144576	Shaft
41	LV10/2930-99-865-4693	IMPELLER, CENTRIFUGAL PUMP		1	16	FV147354	
42	LV10/2930-99-865-4644	GASKET	plate to casing	1	17	FV144593	
43	LV10/2930-99-865-4670	PLATE, CENTRIFUGAL PUMP	backing	1	18	FV141653	
44	LV10/5306-99-865-4662	BOLT, MACHINE	UNF, steel, hex hd, Cd plated, 1/4 in. x 1.557 in.	1	19	FV142308	
45	G1/5310-99-944-0548	WASHER, LOCK	steel, single coil, sq section, Cd plated, 1/4 in.	4	20	FV142147	Backing plate
46	G1/5310-99-941-4136	NUT, PLAIN, HEXAGON	UNF, steel, Cd plated, 1/4 in.	4	21		
				4	22		

BL

Item No.	Catalogue Number	Item Name	Item Description	No. Off	Plate Ref.	Drawing No.	Remarks
1		PUMP, CENTRIFUGAL - Contd					
2	LV6MT1/4730-99-801-1229	LUBRICATING NIPPLE	BSP.F, hydraulic, straight, 1/8 in.	1	83		
3				1	23		
4	LV10/2910-99-865-4635	GASKET	water pump	1		FV141609	Coolant pump to cyl block studs
5	G1/5310-99-120-7357	WASHER, LOCK	steel, single coil, sq section, zinc coated, 5/16 in.	1			
6	G1/5310-99-941-0903	NUT, PLAIN, HEXAGON	UNF, steel, lock, zinc coated, 5/16 in.	1			Coolant pump to cyl block
7	G1/5306-99-941-6591	BOLT, MACHINE	UNF, steel, hex hd, zinc coated, 5/16 in. x 1-3/4 in.	3			
8	G1/5310-99-947-1263	WASHER, FLAT	steel, zinc coated, 5/16 in.	3			RR/KB1077
9	LV10/5310-99-865-1475	WASHER, FLAT	Al, 5/16 in.	3			
10	LV10/2930-99-865-4650	PULLEY, GROOVE	coolant pump	1		FV141663	Pulley cover plate
11	LV10/2930-99-865-4649	COVER PLATE, ACCESS	pulley, front	1		FV141661	
12	G1/5310-99-120-7357	WASHER, LOCK	steel, single coil, sq section, zinc coated, 5/16 in.	4			Pulley cover plate
13	G1/5305-99-941-6546	SCREW, MACHINE	UNF, steel, hex hd, zinc coated, 5/16 in. x 3/4 in.	4			
14	LV10/5305-99-865-1541	SCREW, MACHINE	BA, steel, csk hd, no. 2 x 1/2 in.	4		RR/K2804/Z	Pulley to shaft
15	LV10/3030-99-865-4962	BELTS, V, ENDLESS, MATCHED SET	driving	1		FV141503	Pump inlet
16	LV6MT1/4730-99-801-7934	PLUG, SCREWED	BSP.F, brass, 1/2 in. Al, 0.830 in.	1		RR/RB1098	
17	LV10/5310-99-865-1493	WASHER, FLAT	hotspot to pump	1		FV142184	Hotspot elbow to casing
18	LV10/2805-99-865-4668	PIPE ASSEMBLY	hotspot elbow pipe	1		FV141202	
19	LV10/2930-99-865-4628	GASKET	steel, single coil, sq section, zinc coated, 1/4 in.	2			Coolant pipe to manifold
20	G1/5310-99-120-2166	WASHER, LOCK	UNF, steel, hex hd, zinc coated, 1/4 in. x 1-1/2 in.	2			
21	G1/5306-99-941-6582	BOLT, MACHINE	coolant pipe to induction manifold	1			Hotspot pipe elbow
22	LV10/FV141966	JOINT	UNF, steel, hex hd, zinc coated, 1/4 in. x 1 in.	2			
23	G1/5306-99-941-6580	BOLT, MACHINE	steel, zinc coated, 1/4 in.	2			RR/RB1078
24	G1/5310-99-941-8634	WASHER, FLAT	steel, single coil, sq section, zinc coated, 1/4 in.	2			
25	G1/5310-99-120-2165	WASHER, LOCK	UNF, steel, Cd plated, 1/4 in. x 1-3/4 in.	4		FV141889	Outlet facing
26	LV6MT1/28718	TAP, DRAIN	UNF, steel, Cd plated, 1/4 in. x 1-1/4 in.	2		RR/UA853/Z	
27	LV10/5310-99-865-1476	WASHER, FLAT	thermostat housing to cyl hd	1		FV141892	Thermostat housing to cyl hd
28	LV10/2930-99-865-2536	CASING ASSEMBLY, THERMOSTAT	steel, single coil, sq section, zinc coated, 1/4 in.	3			
29	LV10/5307-99-865-4557	STUD, PLAIN	UNF, steel, zinc coated, 1/4 in.	3			FV669056
30	LV10/5307-99-865-4556	STUD, PLAIN	78 deg C open locating oil pipe to thermostat	1		FV141409	
31	LV10/5330-99-865-2539	GASKET	thermostat	1		FV141410	Locating screw
32	G1/5310-99-120-2166	WASHER, LOCK	Al, 0.201 in.	1			
33	G1/5310-99-941-0924	NUT, PLAIN, HEXAGON	thermostat housing cover	1		FV141984	Housing cover
34	LV6MT1/6620-99-813-0240	THERMOSTAT, FLOW CONTROL	thermostat housing	1			
35	LV10/5305-99-865-2375	SCREW, SET	steel, single coil, sq section, zinc coated, 1/4 in.	4			Adaptor to cyl hd
36	LV10/5310-99-865-2376	WASHER, FLAT	UNF, steel, zinc coated, 1/4 in.	4			
37	LV10/5330-99-865-2579	GASKET	elbow, thermostat housing	1			FV141891
38	LV9ASC/FV 55598	COVER	steel, single coil, sq section, zinc coated, 1/4 in.	2			
39	G1/5310-99-120-2166	WASHER, LOCK	UNF, steel, zinc coated, 1/4 in.	2			
40	G1/5310-99-941-0924	NUT, PLAIN, HEXAGON					
41	LV10/FV 141957	JOINT					
42	LV10/4730-99-865-2538	ADAPTOR, ELBOW, PIPE TO HOSE					
43	G1/5310-99-120-2166	WASHER, LOCK					
44	G1/5310-99-941-0924	NUT, PLAIN, HEXAGON					

Item No.	Catalogue Number	Item Name	Item Description	No. Off	Plate Ref.	Drawing No.	Remarks
1	LV6NT6/4720-99-942-7728	HOSE, RUBBER	7/8 in. id x 1-1/4 in. od	as req			
2	LV6MT1/4730-99-801-1056	CLAMP, HOSE	steel, Cd plated, 7/8 in. to 1-1/2 in.	2			} Thermostat to pump
3	LV10/5330-99-865-4634	GASKET	hotspot pipe	1		FV141349	
4	G1/5310-99-120-2166	WASHER, LOCK	steel, single coil, sq section, zinc coated, 1/4 in.	2			
5	G1/5310-99-944-0924	NUT, FLAIN, HEXAGON	UNF, steel, zinc coated, 1/4 in.	2			} Hotspot pipe to cyl hd

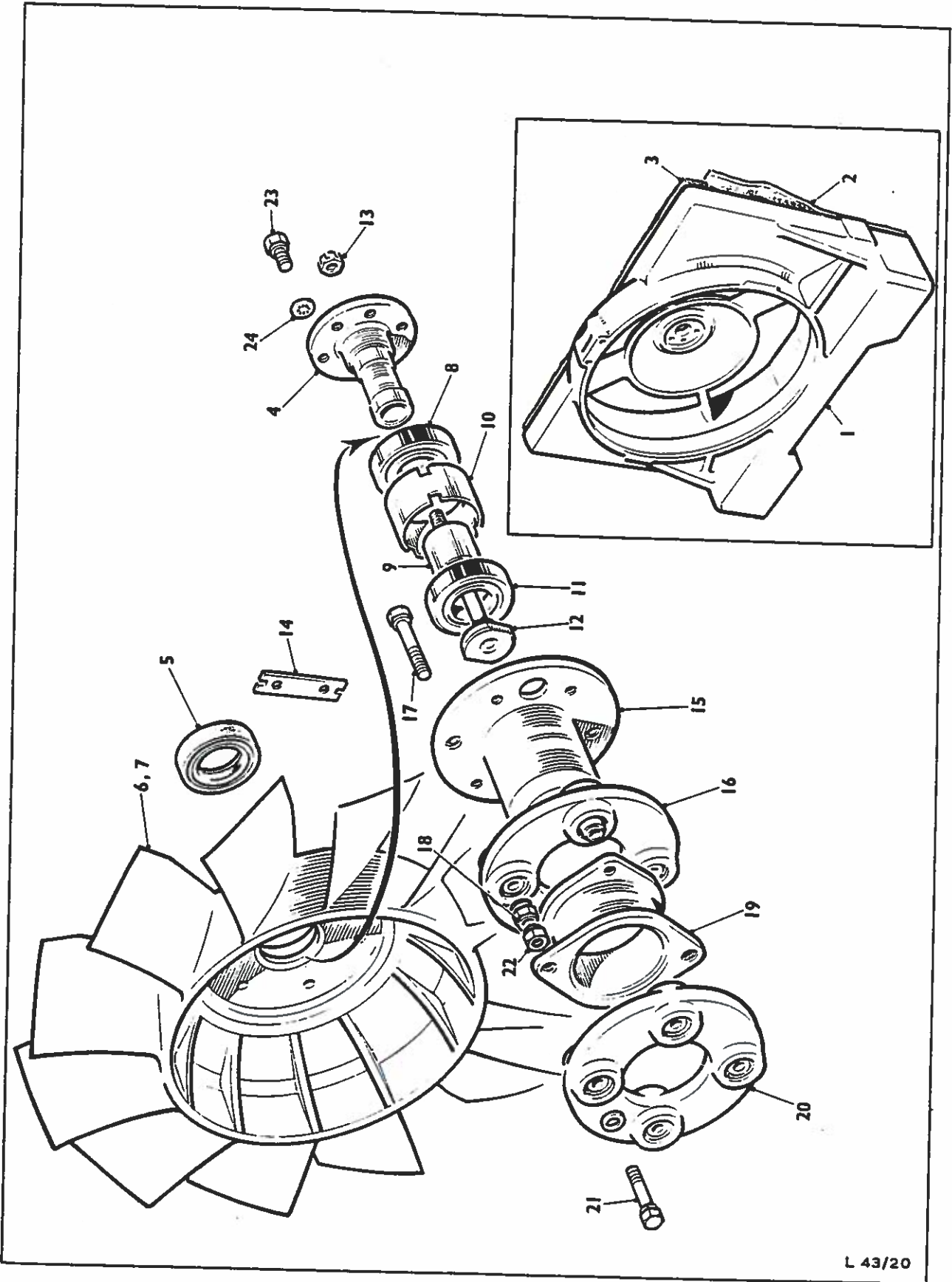

COOLANT PUMP

B 3

